

# MSU Main Library Floor Plan Guide

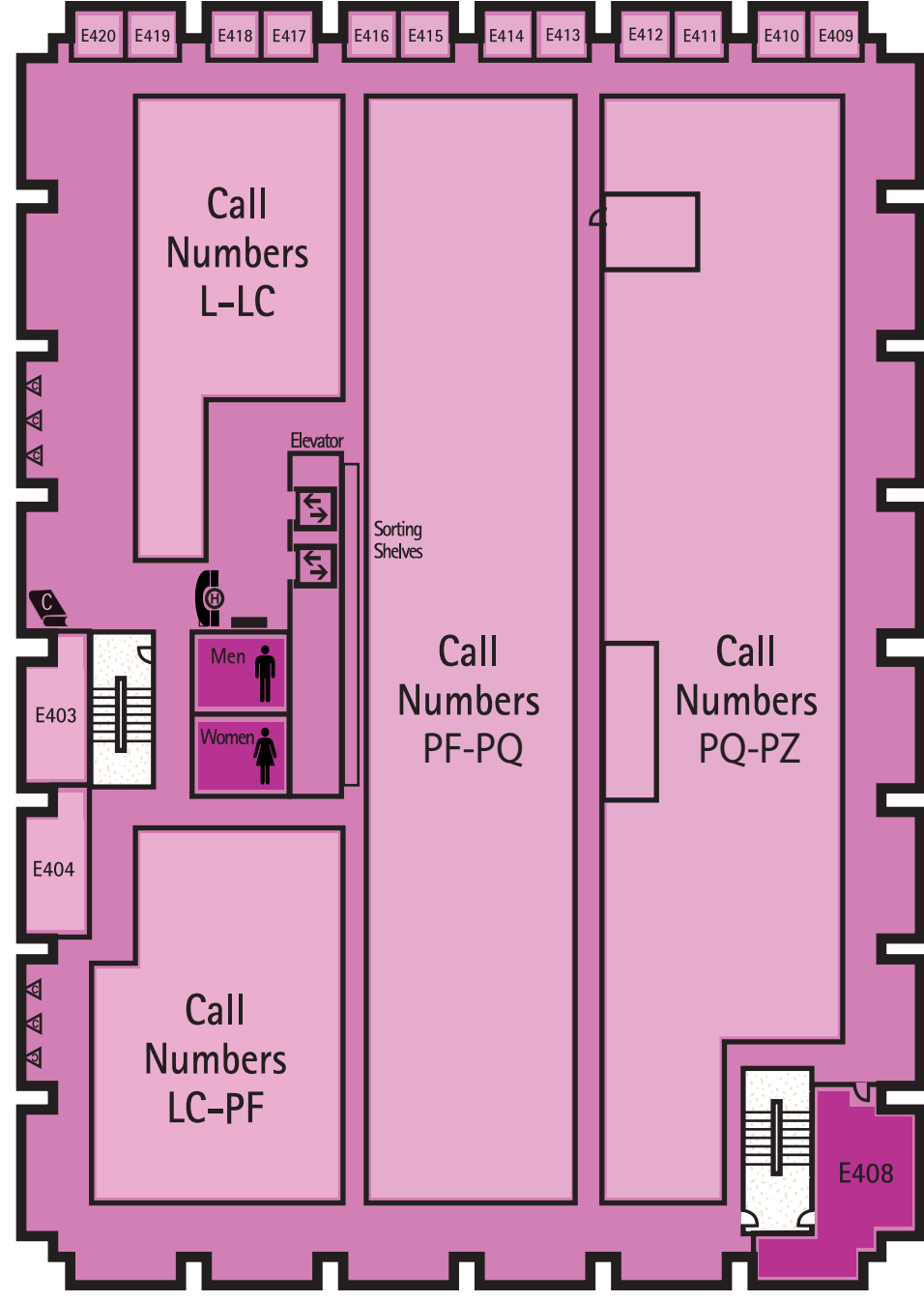

**4-East**  
Call #'s Main L-P  
Faculty Carrels  
(E409-E420)



**4**

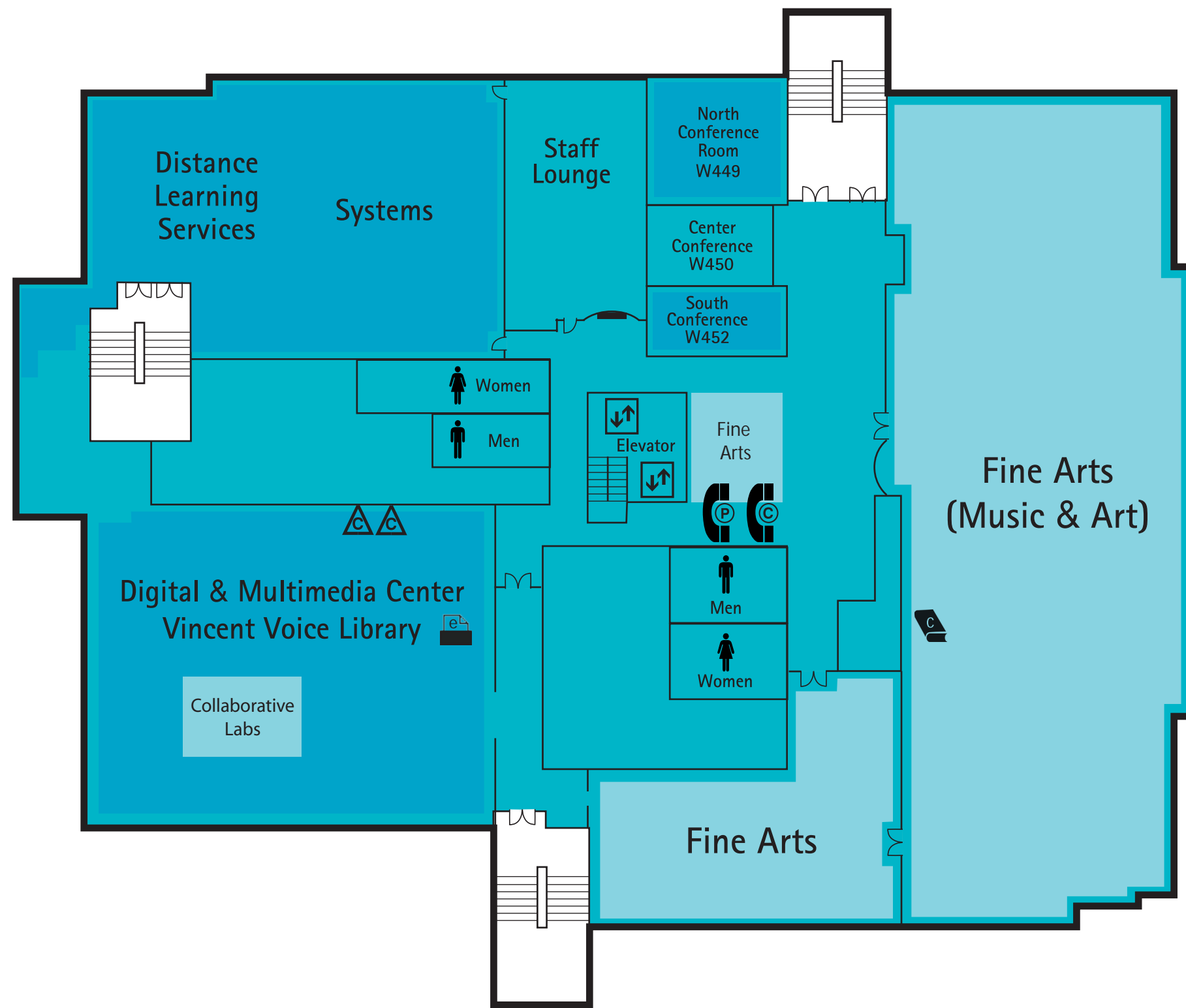

**4-West**  
Collaborative  
Technology Labs  
Digital and  
Multimedia  
Center including  
the Vincent Voice  
Library  
Fine Arts Library  
(Music & Art):  
Call #'s Main M,  
ML, MT, N and TR  
North Conference  
Room (W449)

**3-East**  
Call #'s Main F-J  
Faculty Carrels  
(E309-E320)

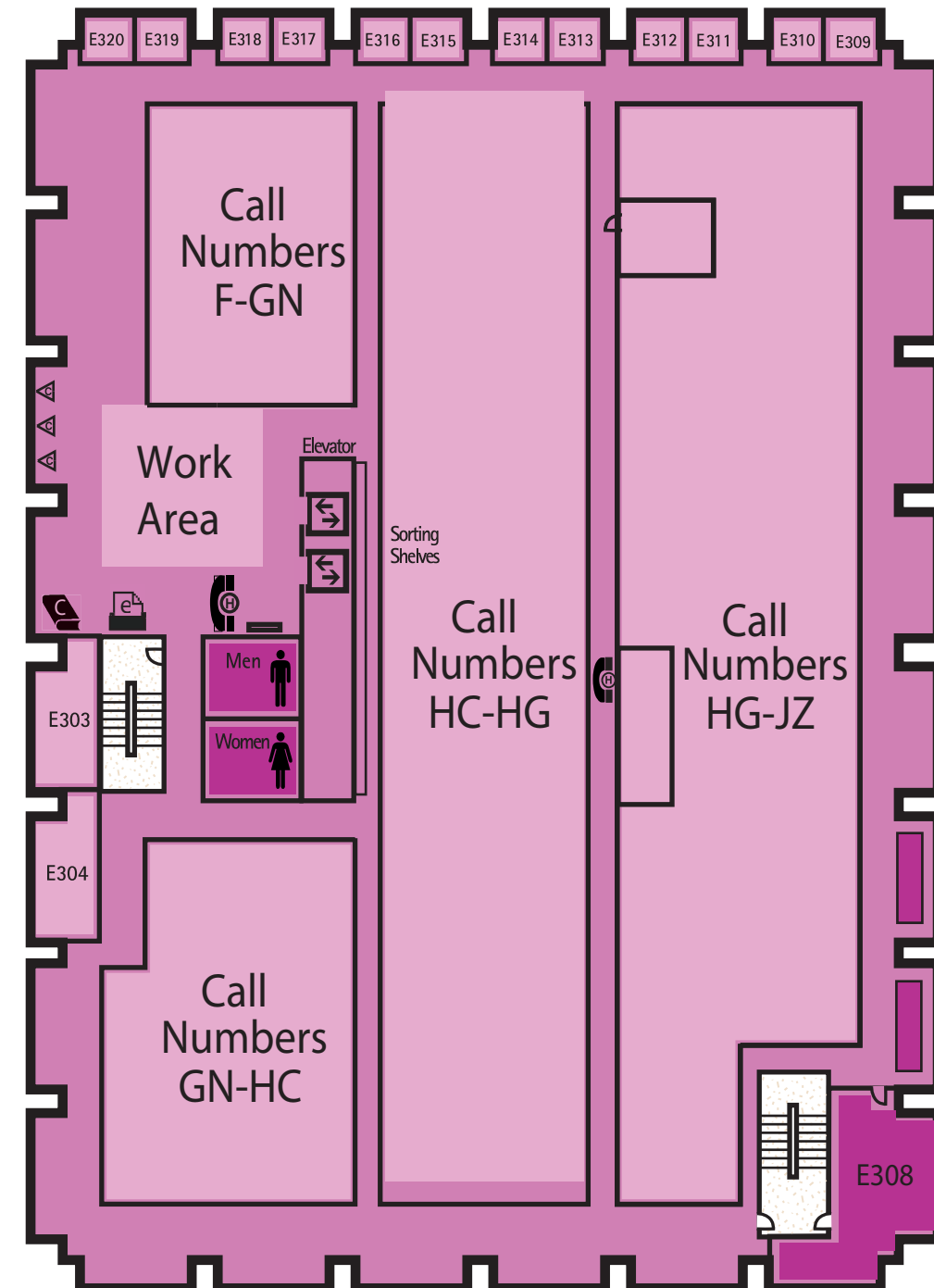

**3**

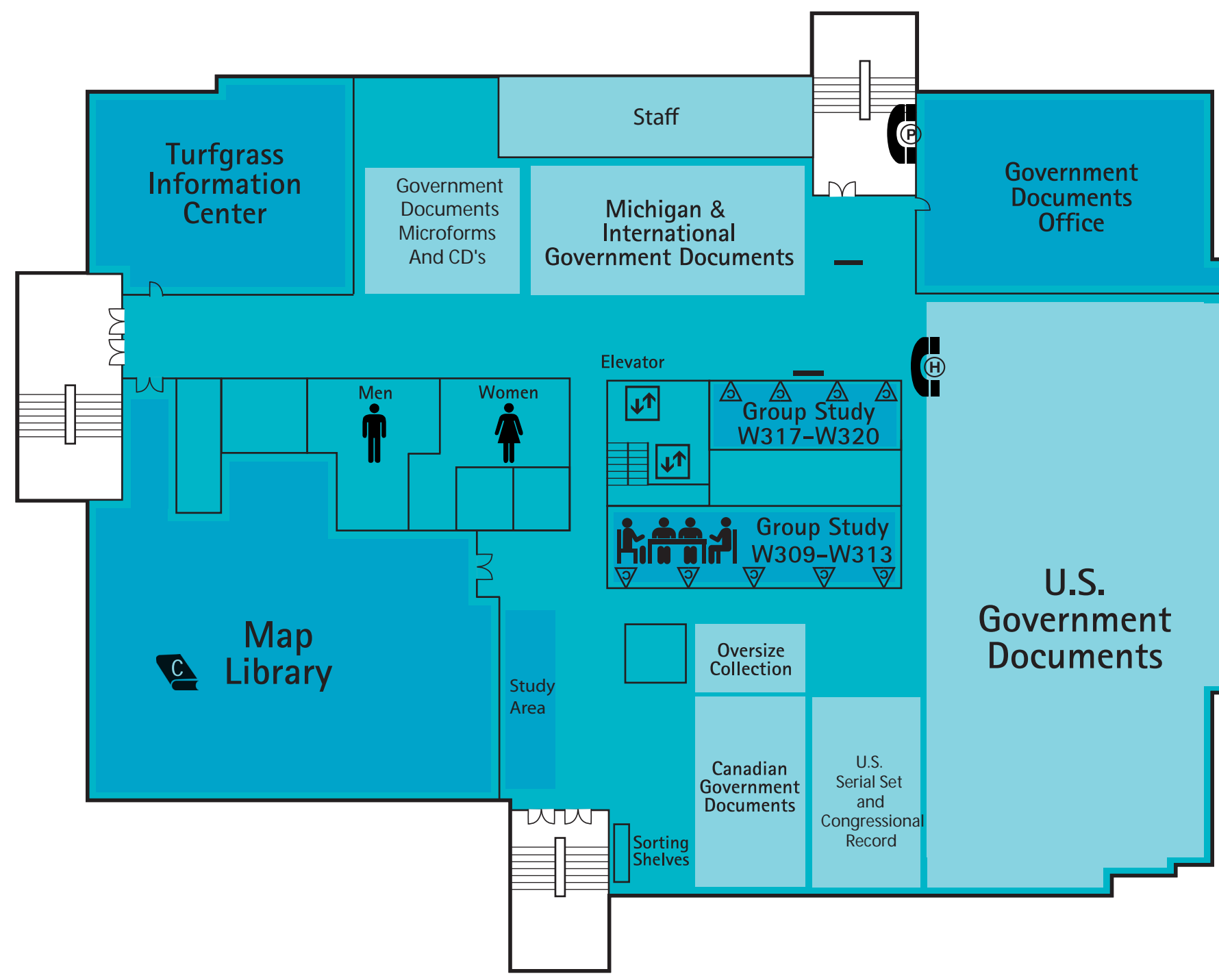

**3-West**  
Labor & Industrial  
Relations Library  
Michigan &  
Canadian Gov. Docs.  
Map Library:  
Call #'s Main  
G1000-9999  
Turfgrass Info.  
Center  
U.S. Government  
Documents

**2-East**  
Call #'s Main A-E  
Africana Reference Coll.  
Area Studies Collection  
Faculty Carrels  
(E209-E220)  
Graduate Carrels  
(E208)  
Graduate Lockers

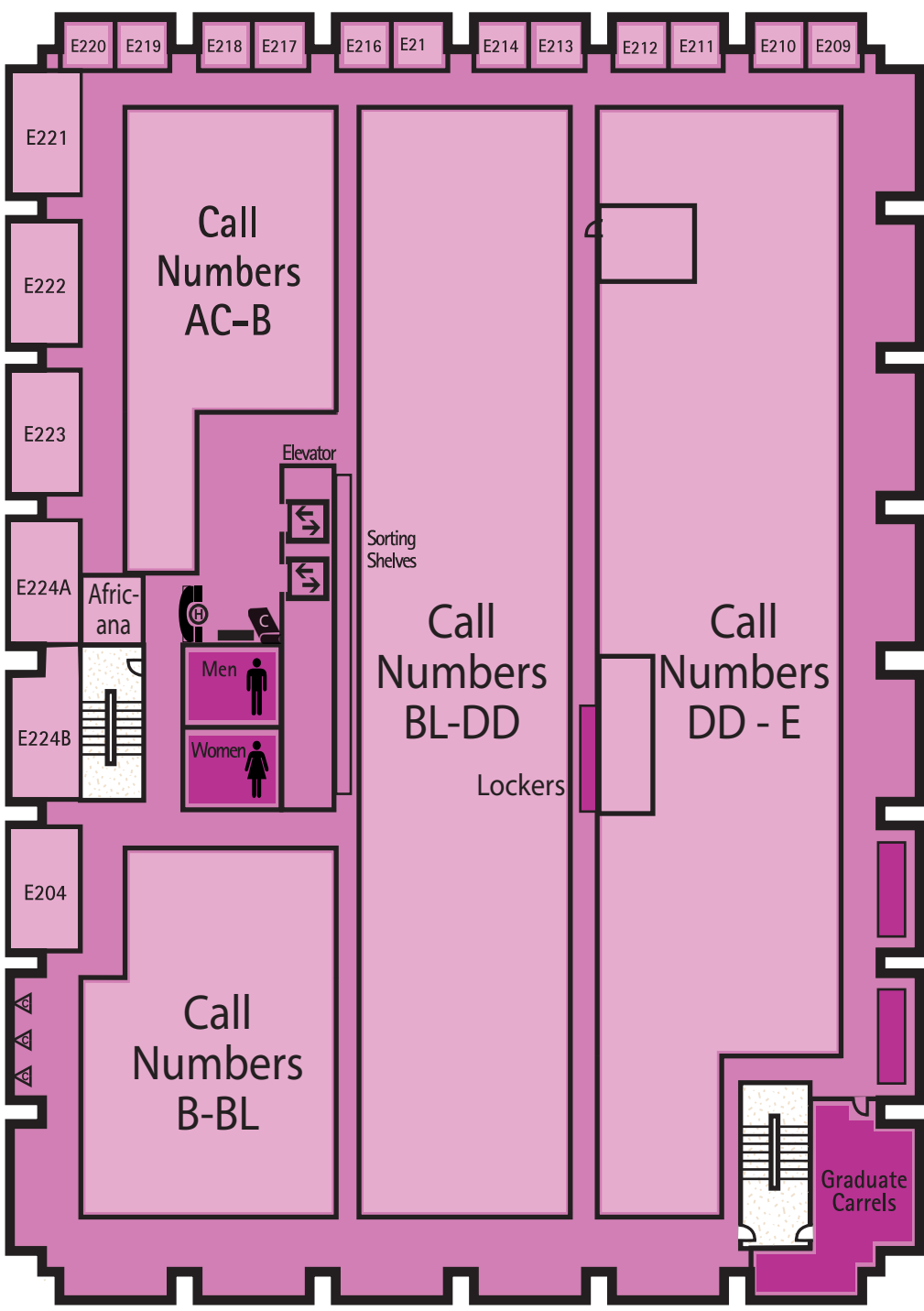

**2**

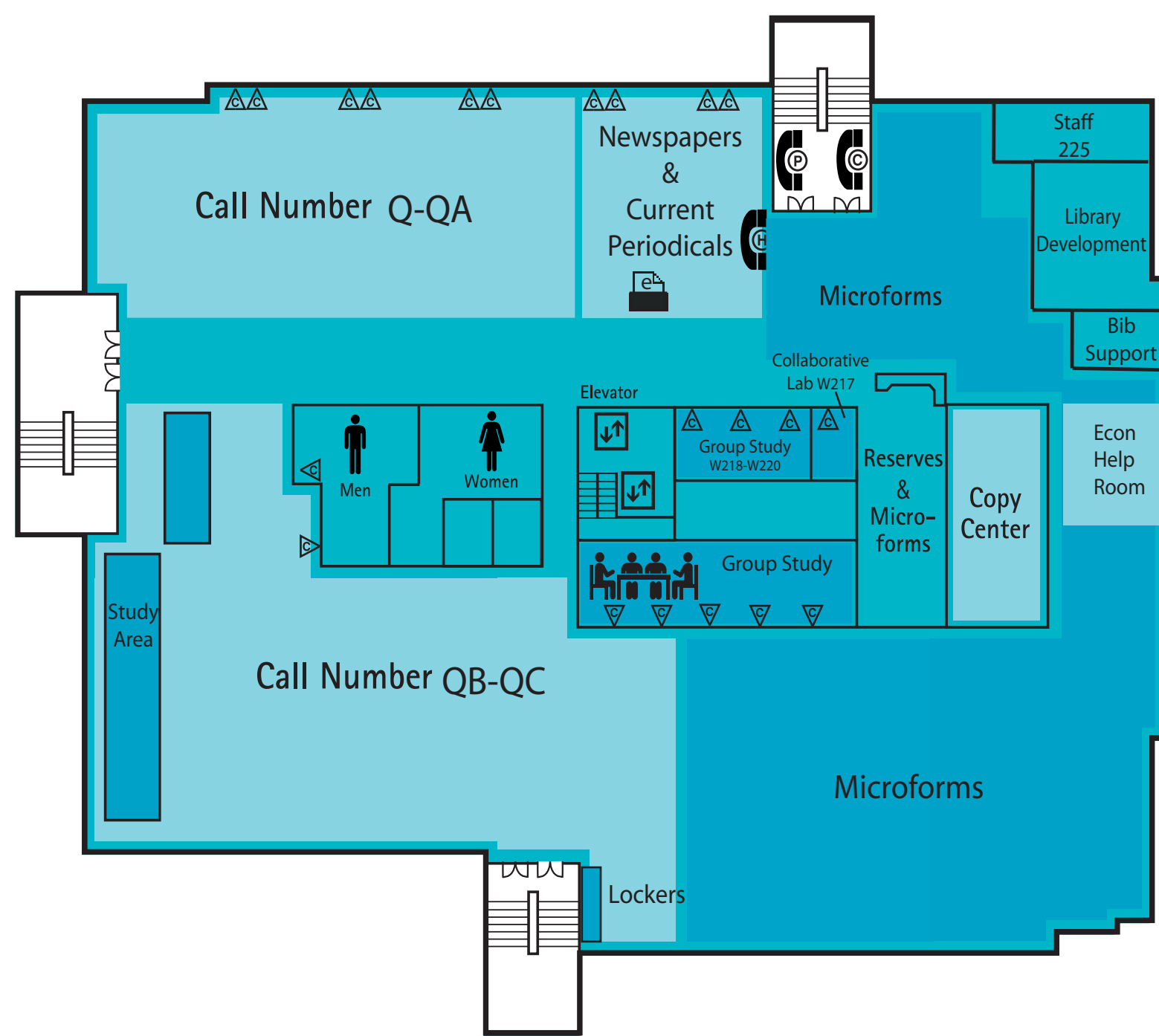

**2-West**  
Call #'s Main Q-QE  
Copy Center  
Microforms  
Collection  
Newspapers &  
Current Periodicals  
Reserve Reading  
& Microforms  
Service Desk

**1-East**  
Beaumont  
Instruction Room  
Browsing Coll.  
Careers/Travel/  
College Guides  
Circulation Desk  
Funding Center  
Government  
Documents  
Reference Coll.  
Reference Coll.  
Reference  
Instruction Room  
Statistics Alcove

**EAST**

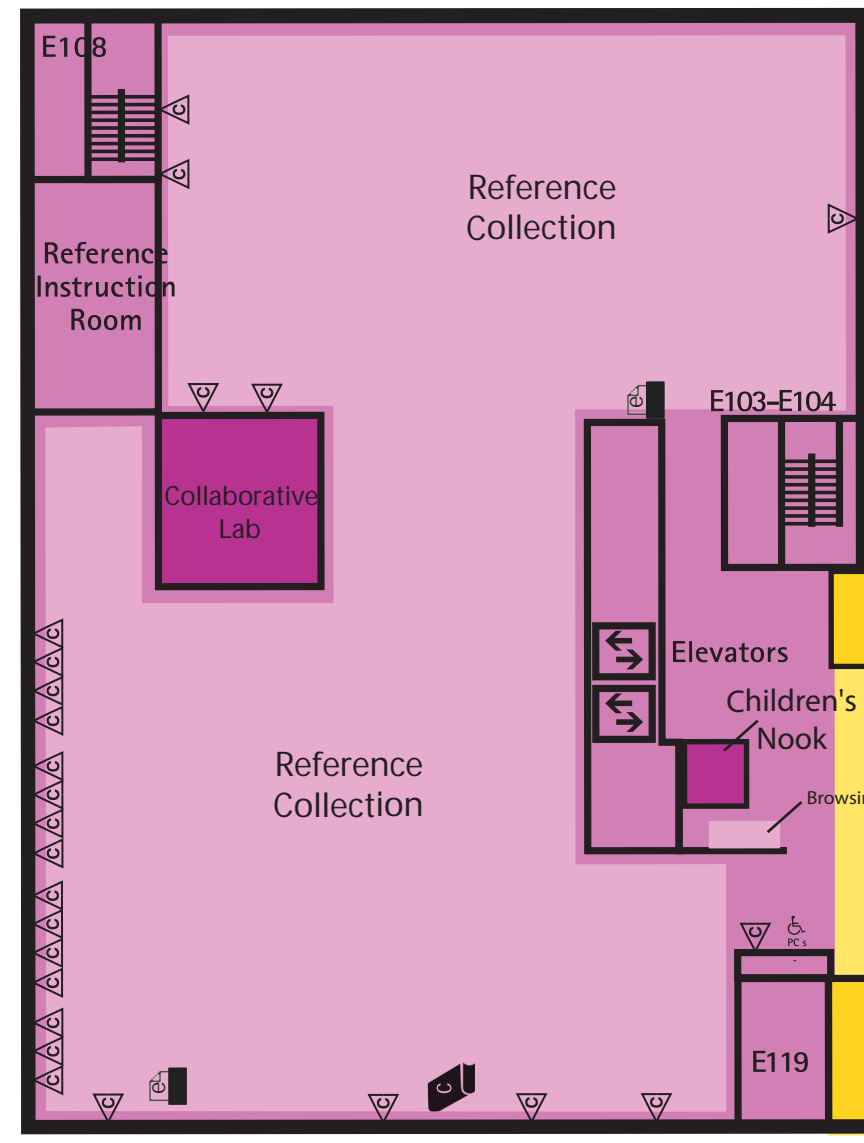

**1**

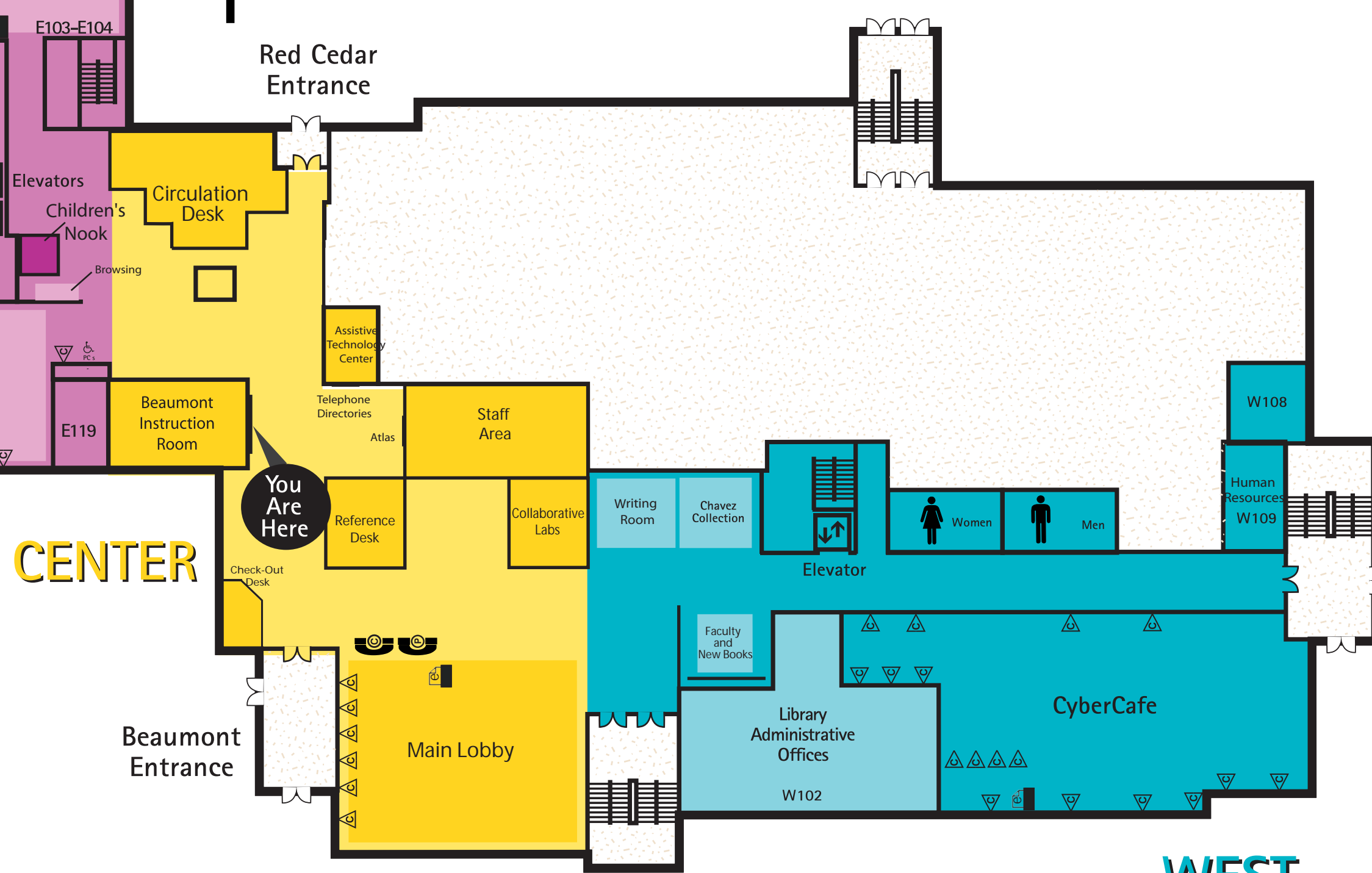

**1-West**  
Chavez Collection  
Cyber Cafe  
Faculty Book  
Collection  
Library  
Administrative  
Offices  
Library Human  
Resources Office

**1-Center**  
Assistive  
Technology Center  
Checkout Desk  
Reference Desk

**EAST**

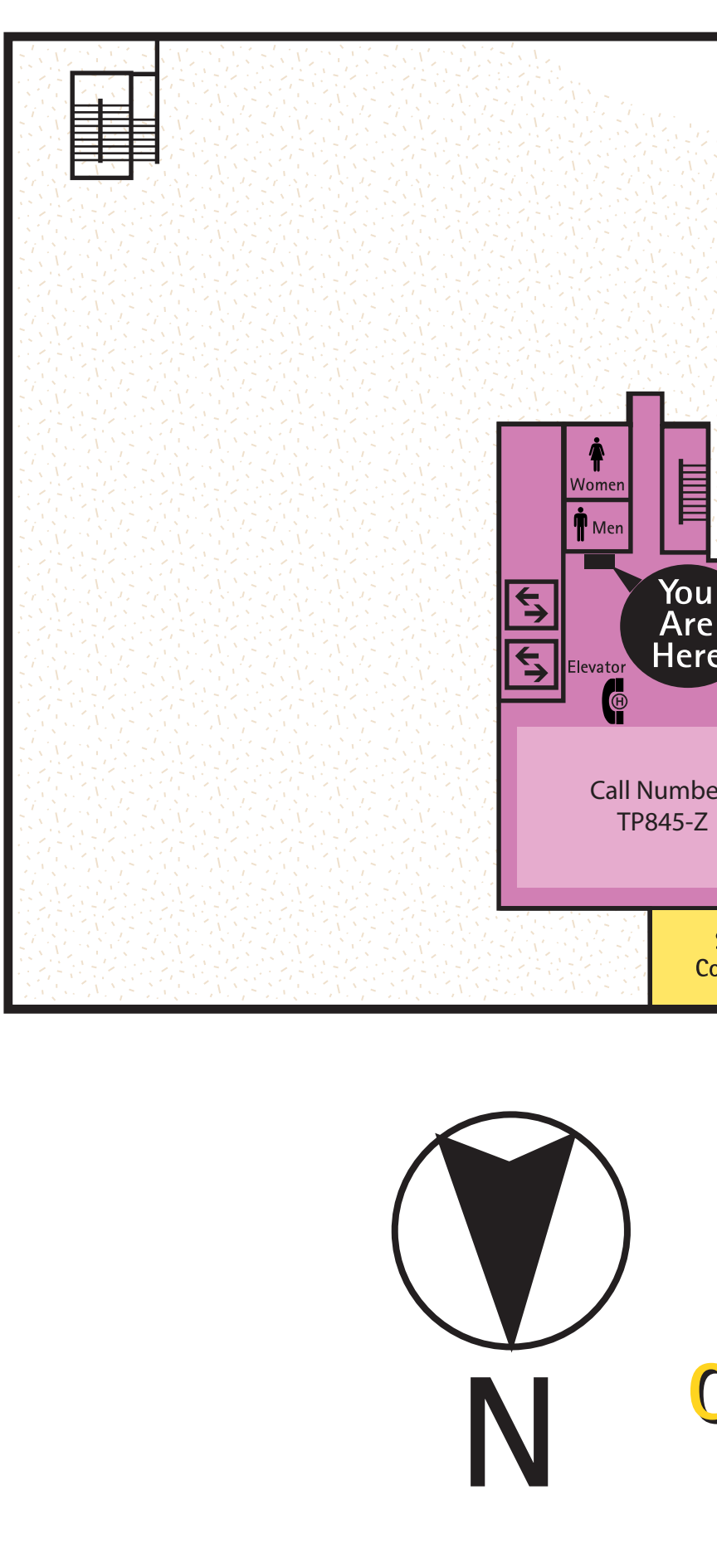

**B**

**WEST**

**Basement-West**  
Call #'s Main  
QH1-RG137.6  
MSU Theses &  
Dissertations



**CENTER**

**WEST**