

# Main Library FLOOR PLAN GUIDE

*NOTE: Locations may have changed due to ongoing space renovations. Please visit a service desk for additional assistance.*

4

**4-WEST**

- Call Numbers M, N & TR (Fine Arts Library)
- Collaborative Tech Labs (A/V Labs W426H & G; Smartboard Labs W426D & F)
- Conference Rooms A and B
- Digital and Multimedia Center (Kline DMC)
- Fine Arts Library (Music and Art)
- ROVI Gaming Area
- Vincent Voice Library

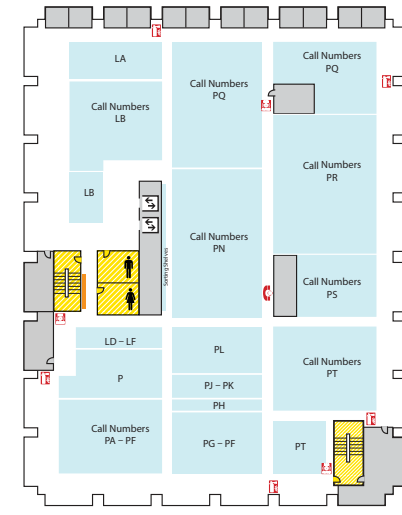

**4-EAST**

- Call Numbers L & P

3

**3-WEST**

- Call Numbers G1000-9999 (Map Library)
- Collaborative Tech Lab (Presentation Lab W308F)
- Government Documents (Canadian, International)
- 3-West Instruction Room (REAL)
- Map Library
- Planning Reports
- Turfgrass Information Center
- U.S. Government Documents

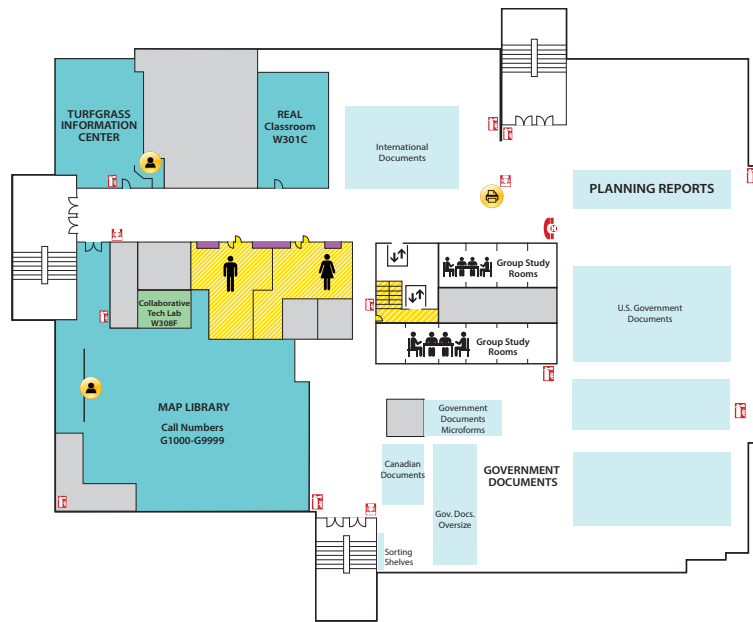

**3-EAST**

- Call Numbers F-J
- Distance Learning Services

2

**2-WEST**

- Group Study Rooms
- Call Number Q-QC
- Children's and Young Adult Literature Collection
- Collaborative Tech Lab (Mediascape Lab W220)
- Copy Center (Hollander MakeCentral)
- Course Materials Program
- Current Periodicals
- Econ & Social Sciences Help Room
- Beaumont Instruction Room
- Red Cedar West Instruction Room
- MakeCentral (Hollander)
- Microforms
- Nursing Mothers' Room

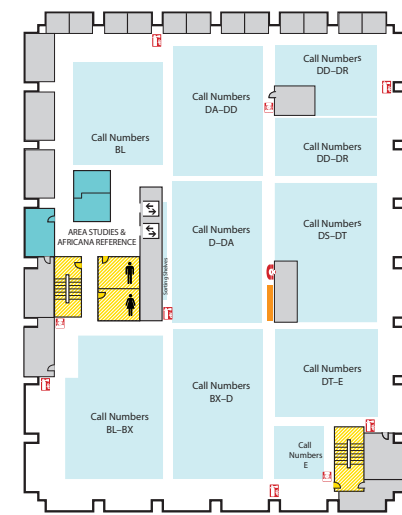
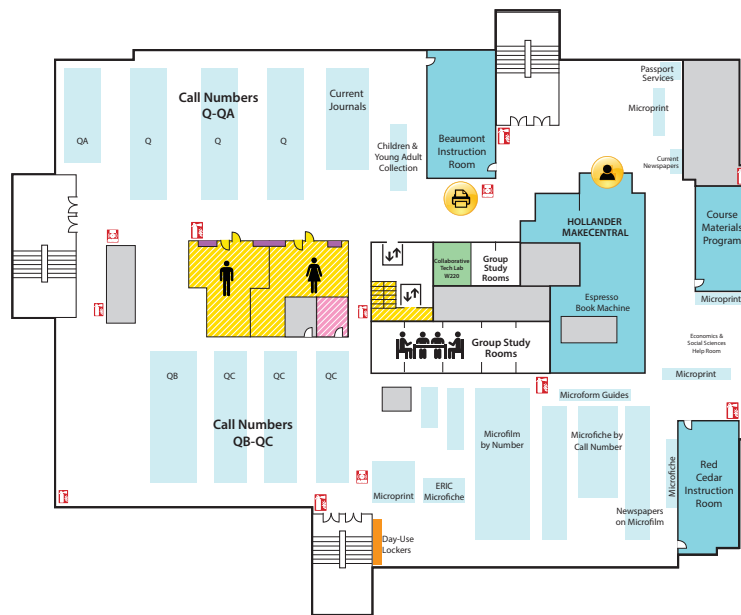

**2-EAST**

- Africana Reference
- Area Studies
- Call Numbers BK-E

1

**First Floor WEST**

- CyberCafe
- Development Office
- Faculty Book Collection (Hollander)
- Human Resources
- New Books
- Student Employment (Library; Human Resources)
- Writing Center

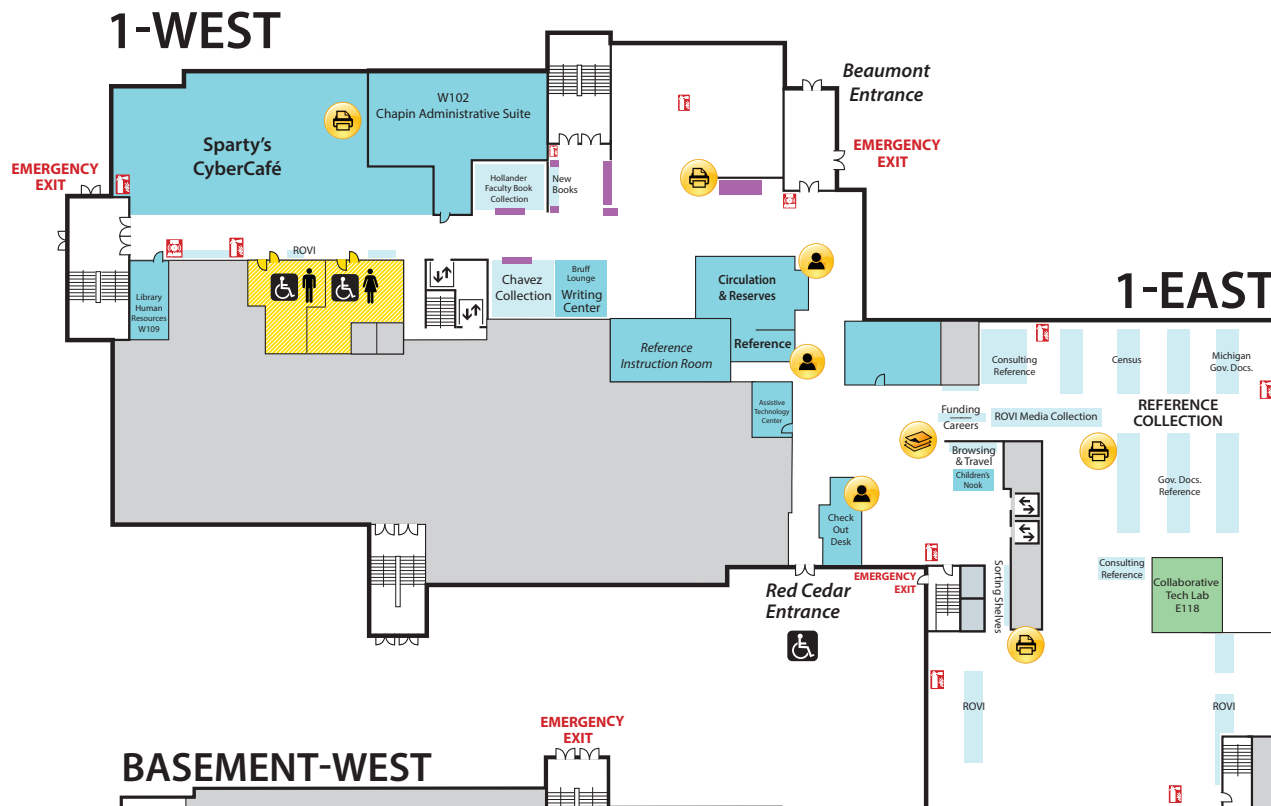

**First Floor CENTER**

- Assitive Technology Center
- Circulation
- Reserves
- Reference Desk (Ask a Librarian)

**First Floor EAST**

- Browsing Collection
- Careers Collection
- Children's Nook
- Collaborative Tech Lab (One Button Room E118)
- Funding Center
- Government Documents (Census, Michigan)
- Reference Collection
- Travel Guides

B

**BASEMENT WEST**

- Call Numbers A-BJ
- Call Number QD-RG

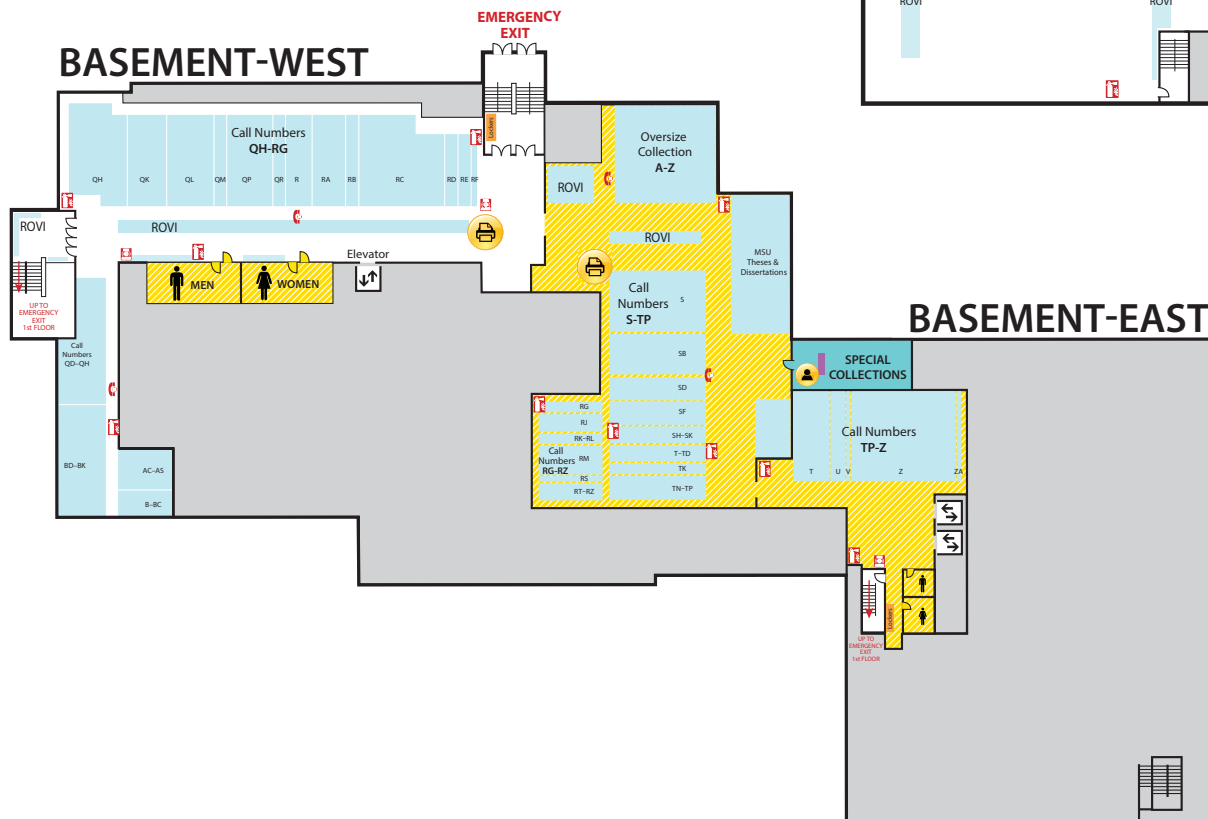

**BASEMENT CENTER**

- Call Numbers RG-TP
- Call Numbers TP-TX (Except TR)
- MSU Theses and Dissertations
- Oversize Books
- Special Collections

**BASEMENT EAST**

- Call Numbers U-Z



North

*Locations may have changed due to ongoing space renovations. Please visit a service desk for additional assistance.*